

Row #s (assigned in GIS mapping and mentioned in many OnBase documents in LE - Cemetery Deeds) start with the number 1 on the eastern edge of each Block.

Drive 7 is steep, gravelly and rutted between Drives D and E. It continues west/downhill into a staging area restricted to Parks and Recreation Department use; no public access.

The actual layout along Drive F is different than shown here. Drives 3-8 stop when they reach Drive F. At its southernmost boundary Drive F bends around into Drive 3, and then continues southward with Block 18 to its right/west and Block 19 on its left/east.

Block 23 is County burials; Blocks 20-22 and D were Catholic-assigned burials.

A Block # outlined in light blue means the City has few or no deeds for the grave plots in that Block.

On 12/12/2017 the City purchased 9.75 acres directly to the north of Block 1 from the Elks for \$400,000, as open space, giving the City future possibilities for burials at Greenmount.

The actual Lot #s in Block 1 are somewhat different than this. They go to Lot 75.

Nobody seems to know the meaning of "Graceland." Do you?

Map for the walking tour of burials in the years of the Spanish Flu epidemic, 1918-19

South

The actual layout at the SE meeting of Drives 3 and D is different than shown here. Neither extends beyond that intersection. Drive 3 bends around in a curve into Drive D.

North

The actual layout of Drive 8 is different than drawn. It doesn't angle over; it is pretty much a straight line between Drives A & F.

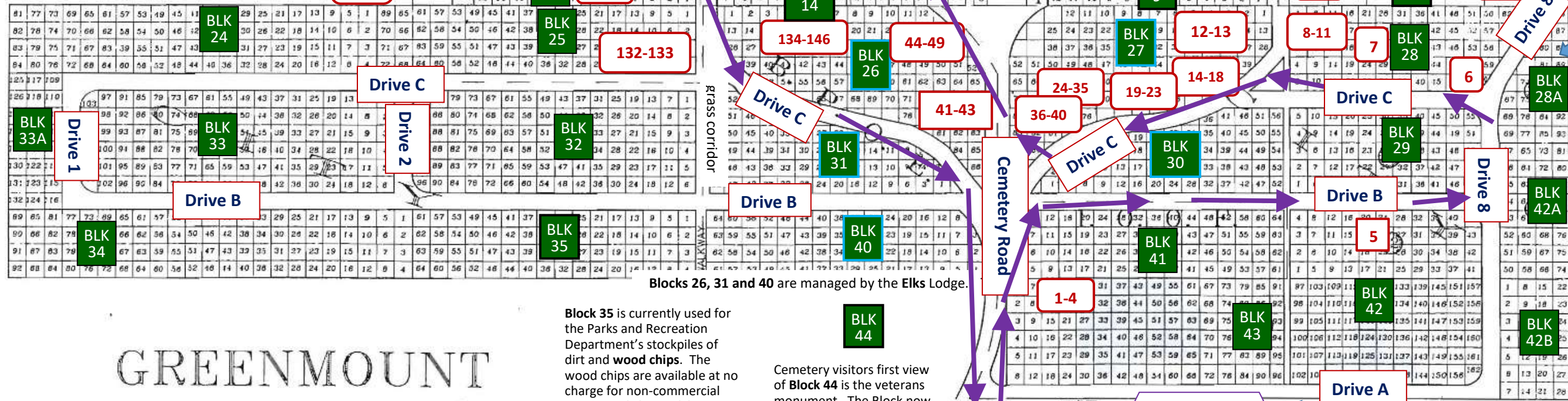

Blocks 26, 31 and 40 are managed by the Elks Lodge.

Block 35 is currently used for the Parks and Recreation Department's stockpiles of dirt and wood chips. The wood chips are available at no charge for non-commercial use. Wood chip mulch is a useful means of improving water retention and soil conditions, especially given the clay soils around here.

Cemetery visitors first view of Block 44 is the veterans monument. The Block now includes grave sites for US veterans. That section is managed similar to a national cemetery; a DD214 discharge document is a requirement for its use.

Block 43 is strictly for cremains, except for some above-ground vaults in its upper portion.

Block 42B is numbered this way because it is where babies are interred.

Last updated 5/12/2020 by Todd Ellison, Records Administrator, City Clerk's Office. Please email your comments and corrections to todd.ellison@durangogov.org

PREPARED BY GOFF ENGINEERING  
NOVEMBER 1991

East





Site No.	Name	Sex	Age <6	Age 6-16	Age 17-39	Age 40-60	Age 61+
3	Anderson, Ferdinand	M					1
49	Andrews, Charles	M			1		
53	Andrews, Mary	F		1			
10	Anesi, Pietro	M				1	
131	Anesi, Rachele	F			1		
62	Anheier, Albert	M				1	
32	Baer, Edward	M				1	
97	Banta, Henry	M			1		
75	Barton, Newton	M				1	
20	Bass, Loisa	F		1			
105	Baudino, baby John Louis	M	1				
105	Baudino, Mary	F			1		
2	Bendure, Stephen	M					1
26	Berri, Beatrice	F	1				
106	Birkner, Charlie	M			1		
89	Blackburn, Bennie	M			1		
11	Bonan, Alex	M				1	
52	Bovee, Zone	M			1		
101	Boyle, Helen	F		1			
82	Boyle, Owen Francis	M					1
23	Brown, Frankie	M			1		
140	Brown, Marie Springer	F			1		
132	Burke, John	M			1		
27	Carbauh, Alfred	M				1	
141	Carr, William	M			1		
86	Carstairs, Agnes	F			1		
102	Casen, Helen	F		1			
7	Chinese man	M			1		
7	Chinese man	M			1		
7	Chinese man [age N/A]	M			1		
100	Conroy, Edith	F			1		
95	Cordova, Juanita	F		1			
104	Cugnini, Patt	M	1				
4	Cummings, Bernard	M		1			
130	Dalla, Antonio	M				1	
17	Dalton, Murville	M				1	
57	Ditchfield, George	M				1	
87	Donald, Mary	F				1	
66	Edwards, George	M			1		
110	Enrico, Ciovanni	M				1	
9	Evans, Minnie	F		1			
34	Farrar, Frances	F		1			
118	Feeley, Sarah	F					1
19	Fletcher, Melvin	M			1		
1	Frech, Andrew	M	1				
1	Frech, Elizabeth	F	1				
1	Frech, Mary	F	1				
1	Frech, Mildred	F	1				
21	Funk, Thomas	M			1		
88	Gagg, Karl	M				1	
78	Gallotti, Ellen	F					1
40	Galloway, Helen	F			1		
96	Garci, J. M. [gender and age not available]	?					

Site No.	Name	Sex	Age <6	Age 6-16	Age 17-39	Age 40-60	Age 61+
83	Gilbert, Isley	M			1		
5	Girardi, John	M				1	
84	Glenn, James	M		1			
139	Gogarty, Minnie	F			1		
64	Graves, Heber	M					1
8	Grisenti, Giovanni	M			1		
8	Grisenti, Giuseppe	M			1		
126	Hamor, Oliver	M			1		
144	Hand, Fillmore	M					1
137	Harmon, Frank	M					1
123	Harrington, Robert	M			1		
14	Harvey, Nettie	F			1		
58	Heather, Kate	F			1		
113	Hegler, Anton ["and daughter," no info on her]	M				1	
79	Hilliker, Charles	M					1
39	Hood, Josie	F			1		
111	Horvat, Frank	M			1		
146	Hott, Robert P., Jr.	M			1		
22	Hughes, Samuel	M					1
143	Hurley, Harry	M			1		
41	Isgar, Marion Basil	M			1		
37	Johnson, Guy	M			1		
65	Johnson, Theodora	F		1			
48	Johnston, Eliza	F					1
36	Jones, James	M				1	
122	Kern, Albert	M			1		
120	Kern, George	M				1	
121	Kern, Harry	M			1		
56	Kerr, Thomas	M					1
13	Knudsen, Marthe	F			1		
136	Kuhn, Fred	M			1		
47	Larson, Andrew	M				1	
72	Lewis, George	M					1
72	Lewis, Sarah	F					1
125	Lissner, Marie	F			1		
18	Lofgren, Anna	M				1	
61	Longwill, James	M			1		
114	Maestaz, Lionardita	F		1			
116	Martinez, Florencia	F					1
109	Martinez, Joseph	M			1		
6	Martinez, Juan	M					1
81	Martinez, Julia	F				1	
92	Mayn, Mary	F			1		
33	McCaw, Alva	M			1		
71	McFadden, Lanah	F					1
46	McGue, Katherine	F			1		
16	McKinley, J. A.	M				1	
134	McLean, Charles	M				1	
68	McNicholas, Robert	M					1
25	Miller, Eva	F			1		
138	Monninger, Laurence	M			1		
129	Murphy, Patrick	M				1	
90	Myers, Elmer	M				1	
43	Nelson, Norrinne	F	1				
103	Nicolino, James	M				1	
108	Pacotti, Antonio	M				1	

Site No.	Name	Sex	Age <6	Age 6-16	Age 17-39	Age 40-60	Age 61+
80	Peake, Ralph	M				1	
74	Peterson, Hardin [Army veteran; age N/A]	M					
124	Petty, Thomas	M			1		
73	Pickerill, Anne [age N/A]	F					
76	Pinson, Bernice	F			1		
59	Powell, Thomas	M			1		
70	Raymond, George	M				1	
91	Raynolds, John	M		1			
133	Real, Mae Burke	F			1		
15	Redman, J. W.	M			1		
94	Rigg, Essel	M			1		
54	Rock, Ilah Davis	F			1		
60	Roff, Ellen Rowland	F				1	
115	Salazar, Frank	M		1			
135	Sanders, Katherine	F				1	
77	Santy, Victor	M			1		
128	Schatz, George	M				1	
85	Schrader, Harry	M				1	
51	Sheets, Daniel	M					1
29	Sheridan, Grace	F					1
28	Silas, Pearl	F					1
44	Sloan infant [gender N/A]	?	1				
145	Smith, L. Elmon [husband?]	M			1		
145	Smith, Layton Eugene [son?]	M	1		1		
145	Smith, Mabel Myers [wife?]	F			1		
30	Snodgrass, Arthur	M				1	
31	Snyder, Theodore	M		1			
42	Soens, John	M				1	
24	Sowers, Jessie [wife]	F				1	
127	Sponsel, John	M			1		
127	Sponsel, Joseph	M			1		
127	Sponsel, Ruth	F		1			
45	Sullenberger, Samuel	M			1		
93	Thompson, Lillian [age?]	F					
63	Timothy, Thomas	M			1		
50	Trujillo, Jose	M			1		
112	Trujillo, Josefita	F				1	
107	Tulio, Nicoletta	F	1				
142	Tyler, Mary	F				1	
117	Vandewiele, mother	F				1	
119	Waldner, Rosa	F			1		
99	Watson, Fredrick	M		1			
69	West, Robert	M		1			
35	White, Frank	M			1		
12	Willis, Herbert [age N/A]	M			1		
55	Willson, Fred	M					1
38	Wright, Elihue	M					1
67	Young, F. Earle	M			1		
98	Young, Mildred	F	1				

A total of 158 individuals. We do not know the gender of two of them. There are nearly twice as many males (101) as females (55). These are the age brackets of the 55 females: 7 of them were less than 6 years old; 9 were 6-16; 21 were 17-39; 8 were 40-60; and 8 were 61 or older [we do not know the age of 2 of the females]. Age brackets of the 101 males: 4 were less than 6 years old; 8 were 6-16; 47 were 17-39; 27 were 40-60; and 15 were 61 or older.